

# Bypass Door Accessory for GearBoss® X-Cart™ and Team Cart™

**Basic Instructions only!**  
 For more detailed product information, refer to the  
**GearBoss High-Density Storage System Owner's Manual 240A099.**

**⚠ CAUTION**

*Make sure anyone assembling, installing or using this product has read and understands these instructions.*

**⚠ CAUTION**

*Failure to comply with Warnings and Cautions in this document or on the equipment can result in damage to property or serious injury.*

**⚠ CAUTION**

*To help avoid damage, more than one person is needed for installation.*

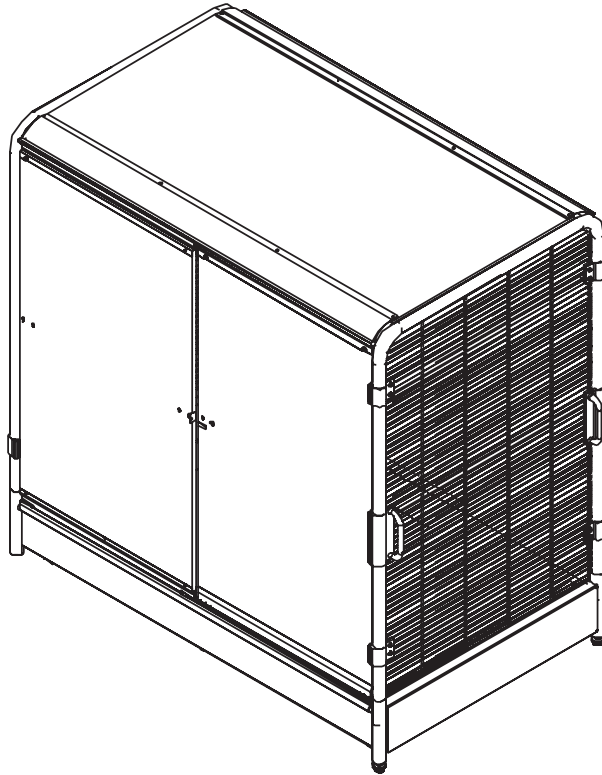

**Bypass Door Accessory on a 48" (1218 mm) X-Cart**

## Contents

Required Tools . . . . .	2	Installation . . . . .	3
Supplied Hardware . . . . .	2	Replacement Parts . . . . .	11
Parts List . . . . .	2		



Visit the GearBoss High-Density Storage System web page at [gearboss.com](http://gearboss.com) for more information.

**Note:** Please read and understand these instructions before proceeding.  
**Note:** If you need additional information, contact Wenger Corporation using the information below.

## Required Tools

- Cordless drill
- 9/16" Combination wrench
- Carpenter's square
- 6" Steel rule
- Mallet

## Supplied Hardware

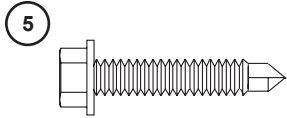

Screw, Self-drill  
10-18 x 1"

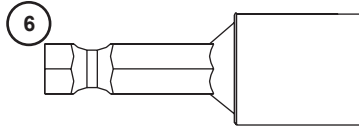

Hex Nut Insert Bit  
5/16"

## Parts List

Item	Qty	Description
1	1	Left Bypass Door
2	1	Right Bypass Door
3	1	Bypass Door Track
4	6	Top Panel Spacer
5	5	10-18 x 1" Self-drilling Screw**
6	1	5/16" Hex Drive Insert Bit**

\*\*Not shown, refer to Supplied Hardware

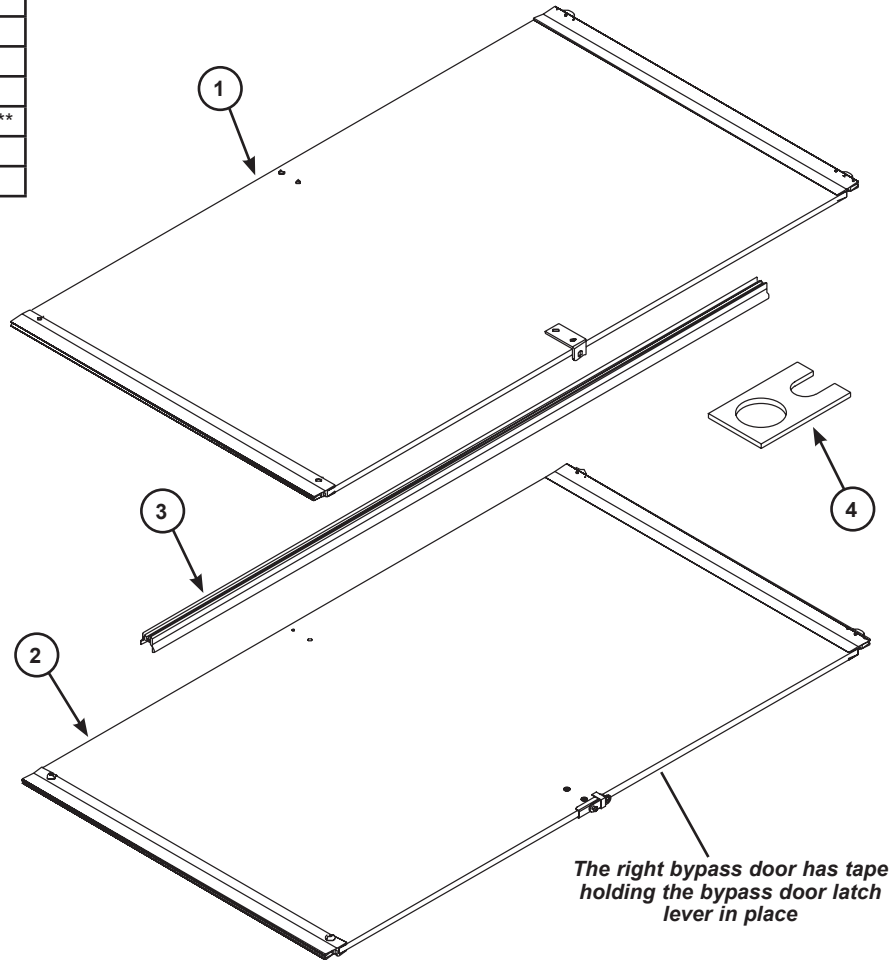

# Installation

## NOTICE

The following instructions are the same for the bypass door accessory installation on a 32" (813 mm) X-Cart, a 48" (1219 mm) X-Cart, or a Team Cart.

### Before Starting the Bypass Door Installation

1. Move the bypass door accessory carton to the work area (it is best to use a work table).
2. Open the carton and inventory the contents. Make sure that all of the required items listed in the Parts List are present including the hardware items.

## NOTICE

Not all hardware items packed in the carton may be needed. When the assembly is complete, discard any hardware items not used.

### Attach the Bypass Door Track

1. Decide which side of the cart to install the bypass door accessory.
2. Place the bypass door track onto the chassis side rail.
  - a. Center the bypass door track on the chassis side rail right-to-left between the two end frame assemblies.
  - b. Gently tap the bypass door track downward with a mallet to engage the chassis side rail.
  - c. Make sure that the top edge of the bypass door track is parallel with the horizontal wires of the wire-grille end panel. Place a carpenter's square across the top edge of the two outside upper bypass door track legs to make sure that the track is correctly positioned.

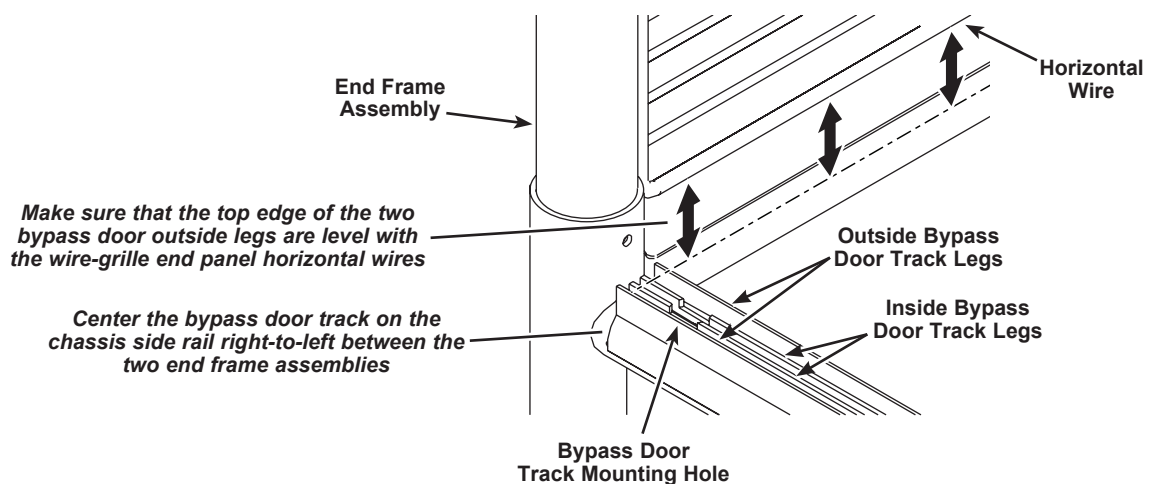
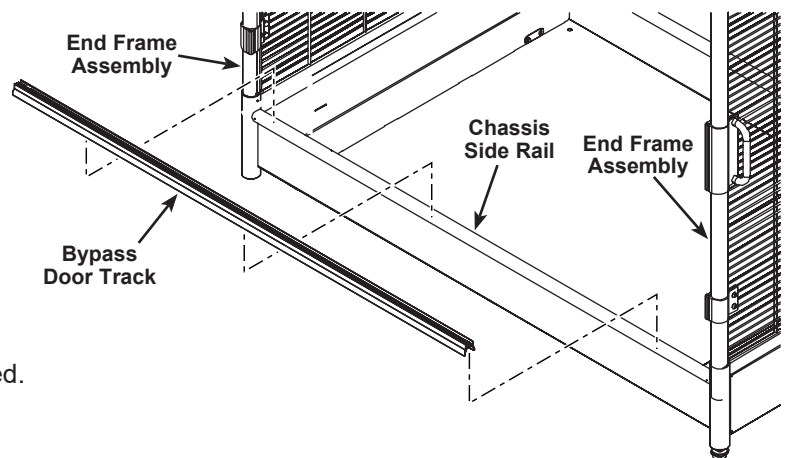

## ***Installation (continued)***

- Using a cordless drill and a 5/16" hex nut drive bit, attach three 10-18 x 1" self-drilling screws to the bypass door track and chassis side rail. Attach a screw at each bypass door track mounting hole by drilling it into the chassis side rail. Make sure that the top of each screw head is below the top edge of the inside bypass door track legs when finished.

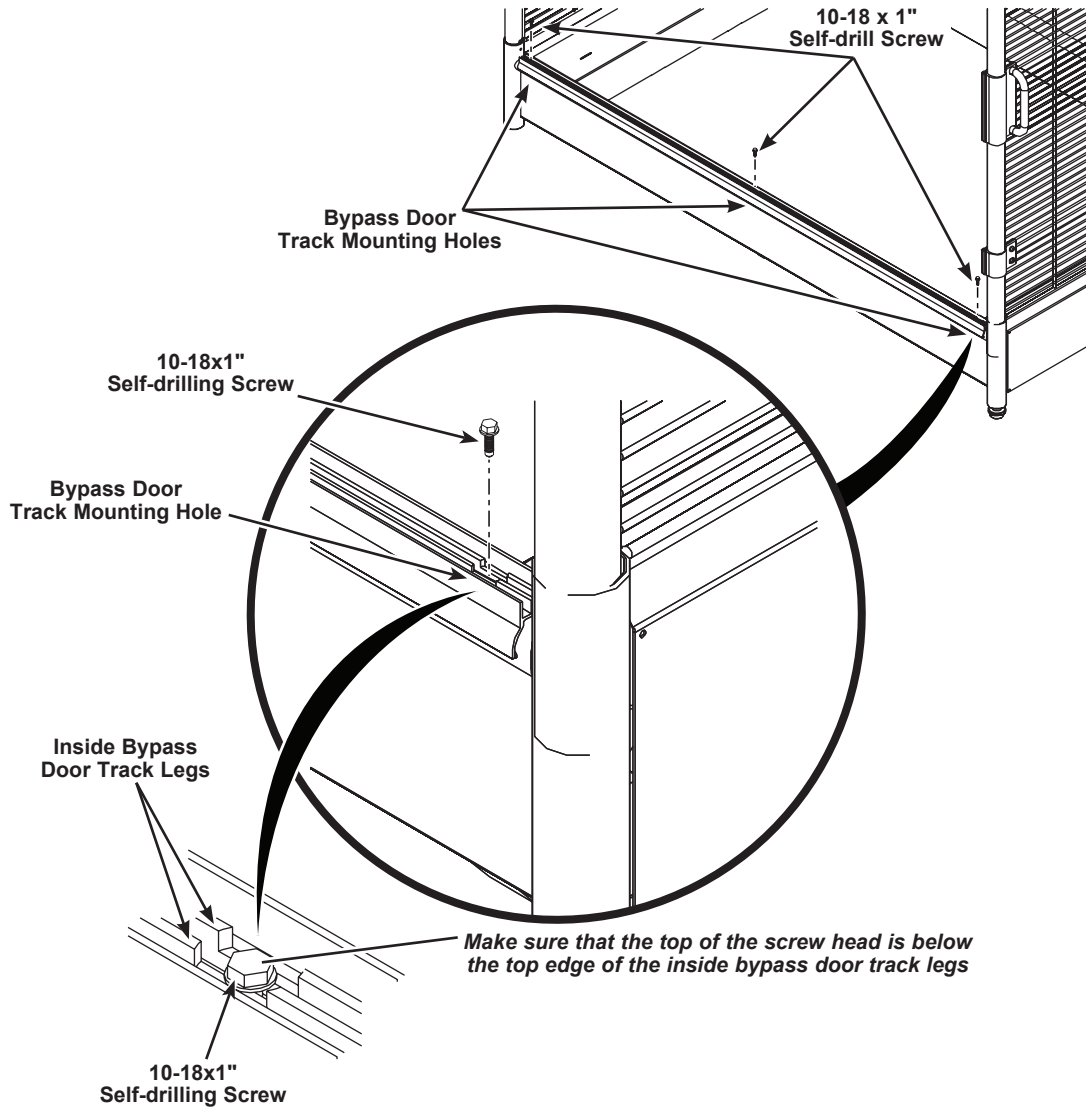

## Installation (continued)

---

### Install the Bypass Doors

1. Using a 9/16" combination wrench, remove the acorn nuts attached to the button head screw at each corner of the top panel assembly as shown in illustrations at the right and below. Set aside and save the two acorn nuts.

#### NOTICE

*It may be necessary to use a step stool to reach the top.*

#### CAUTION

*Never stand on the cart.*

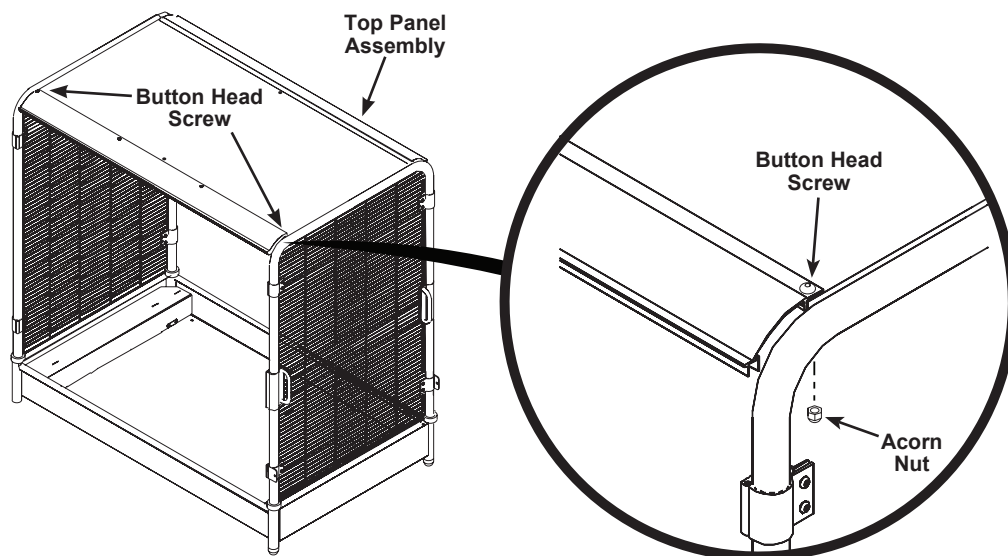

*Remove the two acorn nuts attached to the button head screw at each corner of the top panel assembly*

## Installation (continued)

### NOTICE

*The right bypass door has tape holding the right bypass door latch lever against the right bypass door.*

### NOTICE

*The right bypass door latch and latch lever must face to the inside of the cart and the left hand bypass door latch tongue must face to the outside of the cart.*

2. Place the right bypass door into the bypass door track as follows.
  - a. Hold the right hand bypass door at about a ten-degree angle with the door latch facing the inside of the cart.
  - b. Place the right bypass door wheels into the bypass door track inside channel and hold the door at an angle as shown at the right.
3. Place the left bypass door into the bypass door track as follows.
  - a. One person must continue to hold the right bypass door at an angle with the bypass door wheels resting on the bypass door track inside channel.
  - b. A second person must hold the left bypass door at about a 10° angle with the door latch tongue facing the outside of the cart and place the left bypass door wheels into the bypass door track outside channel as shown in the illustrations at the right and below.

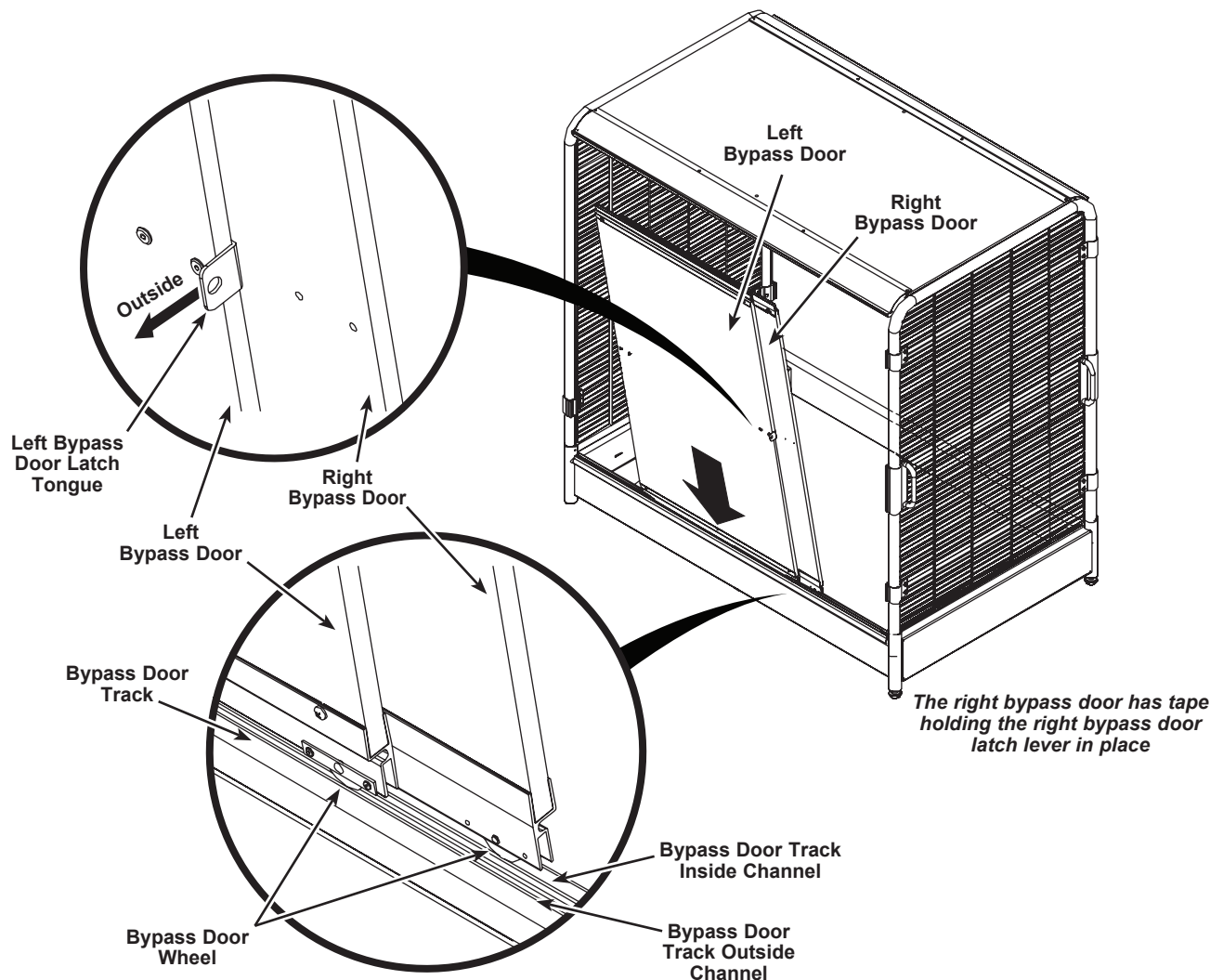

## ***Installation (continued)***

---

4. With one person holding the right bypass door and another person holding the left bypass door, do as follows.
  - a. Each person, working together, should lift the top panel assembly upward about 1".
  - b. Move the right bypass door top bracket upper channel under the top panel extrusion inside leg.
  - c. Move the left bypass door top bracket upper channel under the top panel extrusion outside leg.
  - d. Lower the top panel assembly until it rests on the two end frame support brackets and engages the left and right bypass door top bracket upper channels with the top panel extrusion inside and outside legs as shown in the illustration below.

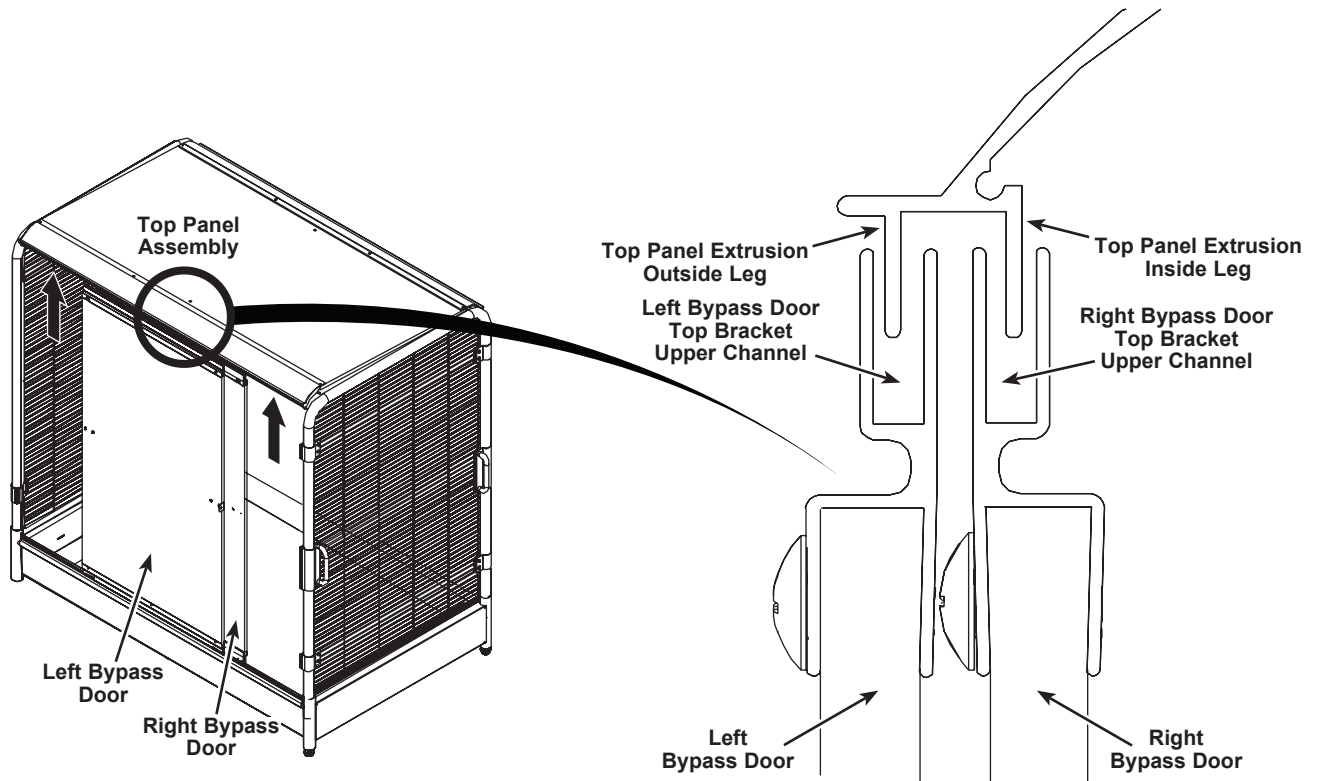

## ***Installation (continued)***

---

### ***Check the Bypass Door Top Clearance***

Check and adjust the clearance between the left bypass door top bracket and the top panel extrusion lip as follows.

1. Move the left bypass door to the left so that the right side of the door is close to the center of the cart as shown below.
2. Using a 6" rule or similar tool, measure the clearance between the top of the left bypass door top bracket and the bottom surface of the top panel extrusion lip as (refer to the illustration below).
  - a. If the measurement is  $3/16"$  (5 mm) or greater, go to step 4 on the next page.
  - b. If the measurement is less than  $3/16"$  (5 mm), go to step 3 on the next page.

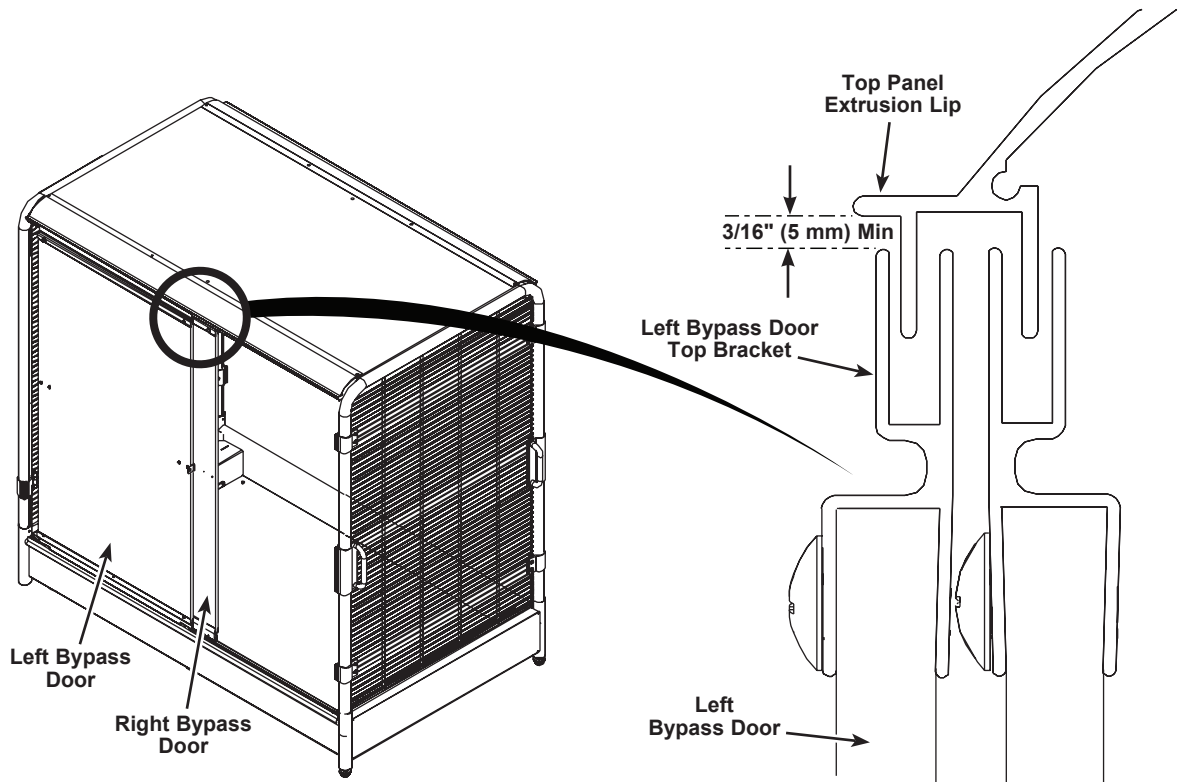



## Installation (continued)

3. To increase the clearance, place top panel spacers between the end frame support bracket and the top panel assembly at each end of the cart as follows.
  - a. On one end of the cart, lift the top panel assembly upward about 1/4" (6 mm) and place a top panel spacer between the top panel assembly and the end frame support bracket. Fit the legs of the top panel spacer around the button head screw.
  - b. Repeat step 3a on the other end of the cart.
  - c. Measure the clearance between the left bypass door top bracket and the top panel extrusion lip. If the clearance is still less than 3/16" (5 mm), repeat steps 3a and 3b.
  - d. Measure the clearance again and repeat steps 3a and 3b if necessary.
  - e. Make sure that the clearance between the right bypass door and the top panel extrusion lip is also 3/16" (5 mm) or greater.

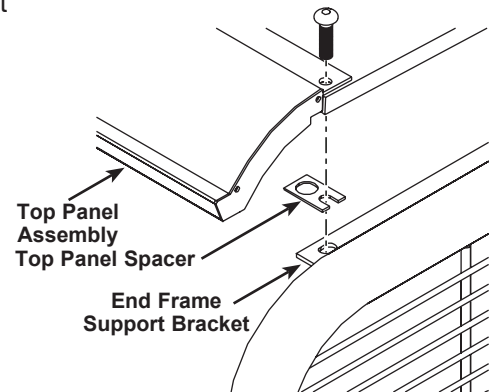

### NOTICE

***If 3/16" (5 mm) clearance cannot be achieved with a total of three top panel spacers on each end of the cart, call Wenger Corporation Customer Service.***

4. Replace the two acorn nuts removed in step 1 of "Install the Bypass Doors" on page 5.

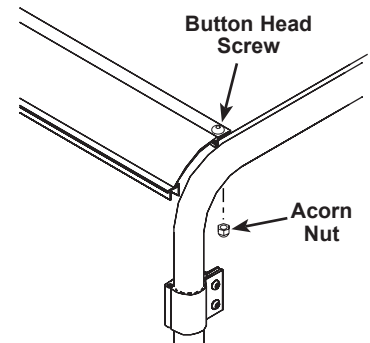

## ***Installation (continued)***

---

5. Remove the tape attached to the right bypass door latch lever and door.

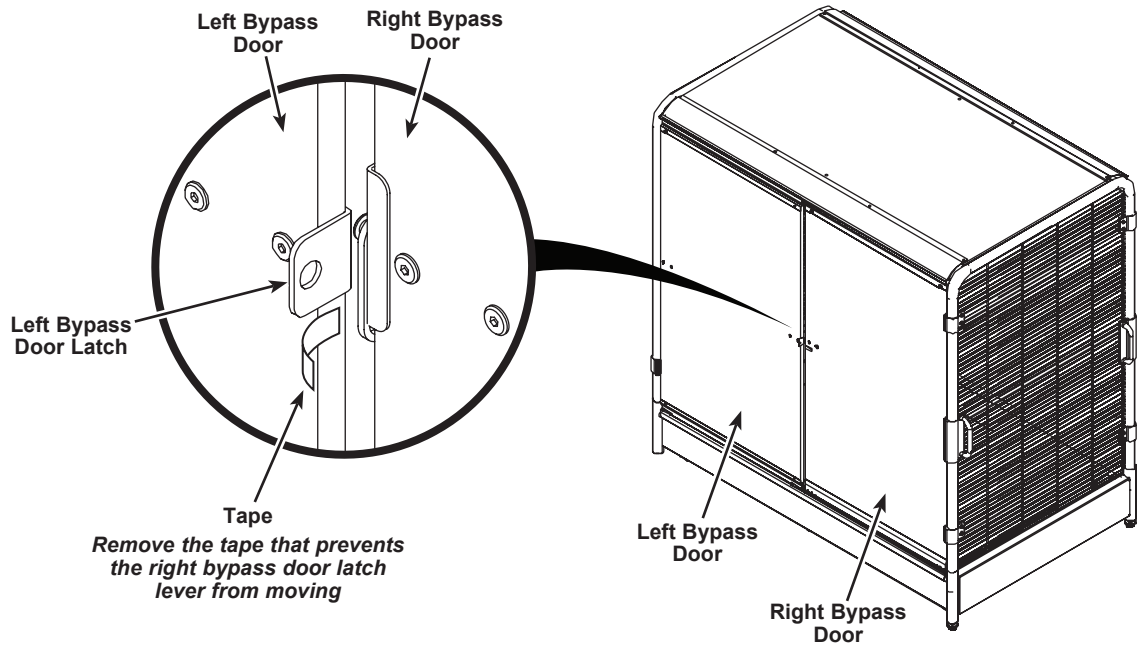

# Replacement Parts

Item	Description	Item	Description
1	Bypass Door Panel	11	10-24 Hex Socket Cap Nut
2	Bypass Door Top Bracket	12	Bypass Door Wheel
3	Bypass Door Bottom Bracket	13	1/4 x 1/2" Bypass Door Clevis Pin
4	Bypass Door Track	14	Bypass Door Clevis Pin Retainer
5	Right Bypass Door Latch	15	10-18 x 5/8" Phillips Pan Head Screw
6	Right Bypass Door Latch	16	1/8 x 1/4" Rivet
7	Right Bypass Door Latch Lever	17	3/8-16 x 3/4" Truss Head Screw
8	10-24 Phillips Head Cap Nut	18	3/8-16 x 7/16" Tee-Nut
9	10-24 x 3/8" Truss Head Screw	19	10-18 x 1" Self-drilling Screw
10	10-24 x 3/8" Truss Head Screw	20	Top Panel Spacer

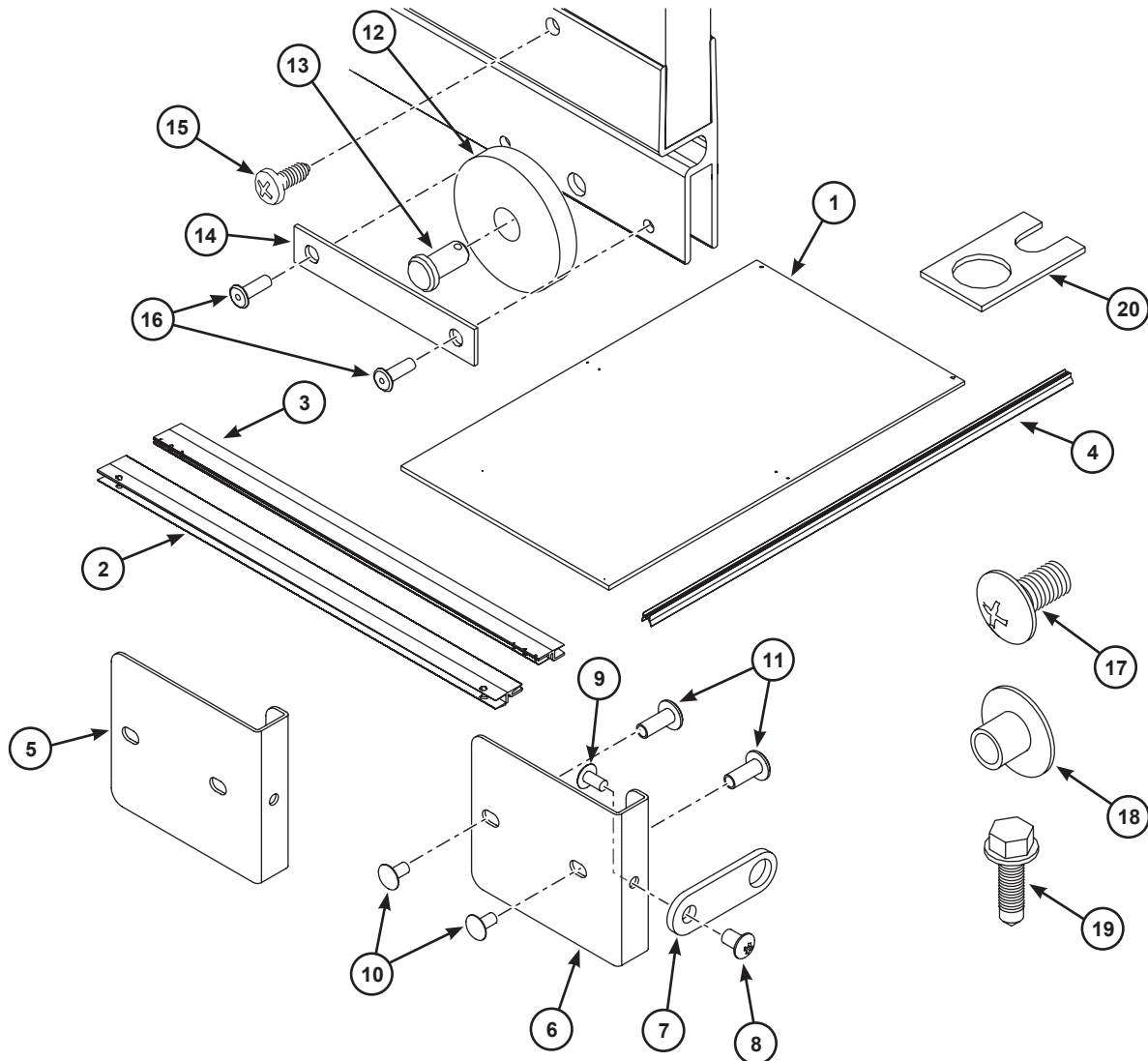

This page is intentionally blank.